

# Installation Manual

AS-3234  
ARNOTT  
REAR AIR STRUT  
JAGUAR XJ SERIES (X351)  
RWD/AWD, SWB/LWB - LT/RT

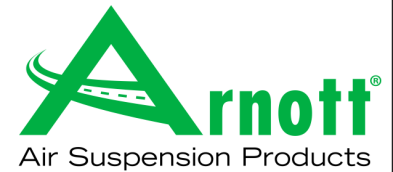

Congratulations on your purchase of an Arnott® air suspension product. We at Arnott Incorporated are proud to offer a high quality product at the industry's most competitive pricing. Thank you for your confidence in us and our product.

Proper installation is essential to experience and appreciate the benefits of this system. Please take a moment to review these installation instructions before you begin to install these components on your vehicle. The removal and installation of air suspension products should only be performed by a fully qualified, ASE Certified, professional.

It is equally important to be aware of all necessary safety measures while installing your new Air Suspension System. This includes proper lifting and immobilizing of the vehicle and isolation of any stored energy to prevent personal injury or property damage.

**"Engineered to Ride, Built to Last®"**



**WARNING:** *The air suspension system is under pressure (up to 10 bar, or 150 lbf/in). Verify pressure has been relieved and disconnect power to the air suspension system prior to disassembly. Do not allow dirt or grease to enter the system. Always wear standard hand, ear, and eye protection when servicing the air suspension system.*

Arnott® is committed to the quality of its products. If you have a question or problem with any Arnott product, please contact Arnott by calling **800-251-8993** during normal business hours or email [techassistance@arnottinc.com](mailto:techassistance@arnottinc.com). (In the EU please call +31 (0)73 7850 580 or email [info@arnotteurope.com](mailto:info@arnotteurope.com))

# Installation Manual

AS-3234  
ARNOTT  
REAR AIR STRUT  
JAGUAR XJ SERIES (X351)  
RWD/AWD, SWB/LWB - LT/RT



## GENERAL INFORMATION:

Reading this manual signifies your agreement to the terms of the general release, waiver of liability, and hold harmless agreement, the full text of which is available at [www.arnottinc.com](http://www.arnottinc.com).

- Not to be stored below 5°F (-15°C) or above 122°F (50°C).
- Avoid damage to air lines and cables.
- Removal and installation is only to be performed by fully qualified personnel.
- Use car manufacturer's diagnostic software.

**CAUTION:** Damage to the vehicle and air suspension system can be incurred if work is carried out in a manner other than specified in the instructions or in a different sequence.



To avoid the possibility of short circuits while working with electric components consult your owner's manual on how to disconnect your battery.



Consult your vehicle owner's manual, service manual, or car dealer for the correct jacking points on your vehicle and for additional care, safety and maintenance instructions. Under no circumstances should any work be completed underneath the vehicle if it is not adequately supported, as serious injuries and death can occur.



This vehicle contains a "Closed Air Supply System". Replacement of components requires proper adherence to procedures set forth within OE servicing literature. Failure to comply with the OE prescribed procedures can result in component damage and/or failure.

## **NOTE:**

With vehicle properly lifted, shift the car into neutral to release tension on the rear suspension prior to disassembly.

## AIR STRUT REMOVAL

1. RAISE VEHICLE.
2. REMOVE APPLICABLE REAR WHEEL. (FIGURE 1)



FIGURE 1

3. IN THE TRUNK, REMOVE THE SPARE WHEEL COVER AND APPLICABLE SIDE TRIM. (FIGURES 2, 3, 4, 5)



FIGURE 2



FIGURE 3



FIGURE 4



FIGURE 5

4. DISCONNECT THE STRUTS ELECTRICAL CONNECTION. (FIGURE 6)



FIGURE 6

5. USING A WRENCH, DISCONNECT THE AIR LINE FROM THE CHECK VALVE. (FIGURE 7)



FIGURE 7

6. REMOVE THE AIR LINE FITTING FROM THE AIR HOSE AND DISCARD. (FIGURE 8)

## REMOVAL



*Prior to inserting the existing air line into the new air fitting you will need to remove the old original equipment air line fitting.*

**NOTE:** SCRATCHES AND/OR DEEP CUTS IN THE AIR LINE CAN RESULT IN POSSIBLE LEAKS. INSPECT THE AIR LINE BEFORE INSERTION. AIR LINE NEEDS TO BE REPLACED IF DAMAGED.

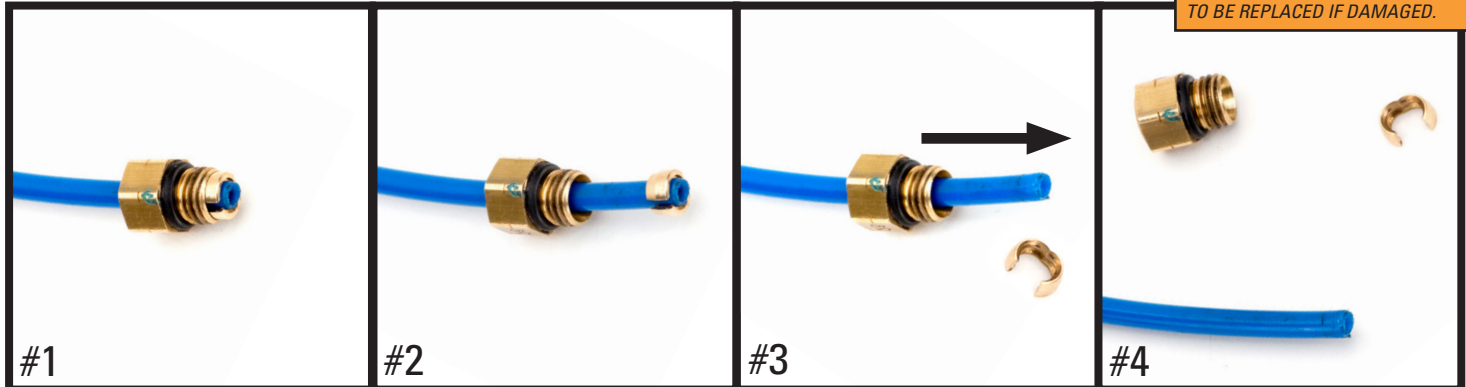

OE AIR LINE FITTING

SLIDE THE THREADED PORTION UP THE LINE AND SPREAD THE COLLET OPEN TO REMOVE

SLIDE THE AIR FITTING OFF OF THE AIR LINE

AIR LINE IS READY FOR INSTALLATION

FIGURE 8

7. REMOVE THE FOUR (4) AIR STRUT MOUNTING NUTS. (FIGURE 9)



FIGURE 9

8. LOOSEN AND REMOVE THE LOWER SWAY BAR END LINK NUT THEN DISCONNECT END LINK. (FIGURES 10 , 11)



FIGURE 10



FIGURE 11

9. DETACH THE REAR TIE ROD. (FIGURES 12, 13)

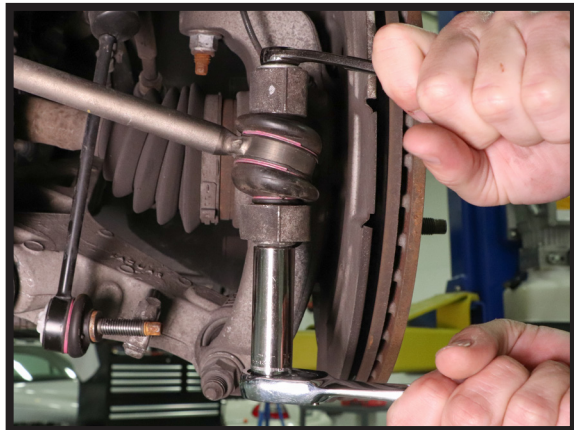

FIGURE 12



FIGURE 13

10. REMOVE THE LOWER AIR STRUT MOUNTING BOLT. (FIGURE 14)



FIGURE 14



11. REMOVE STRUT FROM VEHICLE. (FIGURE 15)



FIGURE 15

12. REMOVAL COMPLETE.

## AIR STRUT INSTALLATION

-  *Tighten all nuts and bolts to manufacturer's specifications during the installation process.*
-  *Do not remove the air fitting from the air strut. Doing so may cause damage and/or void warranty. Remove the white shipping pin from the new air fitting and insert the air line until fully seated.*

1. PREPARE THE AIR STRUT BY REMOVING THE BLACK THREADED PLASTIC PLUG FROM THE VALVE ON THE AIR STRUT AS DEMONSTRATED BELOW. (FIGURE 16)



FIGURE 16

2. INSTALL STRUT INTO VEHICLE. (FIGURE 17)



FIGURE 17

3. INSTALL LOWER STRUT MOUNTING BOLT AND TIGHTEN TO MANUFACTURER'S SPECIFICATIONS. (FIGURE 18)



FIGURE 18

4. INSTALL TIE ROD BOLT/NUT AND TIGHTEN TO MANUFACTURER'S SPECIFICATIONS. (FIGURES 19, 20)

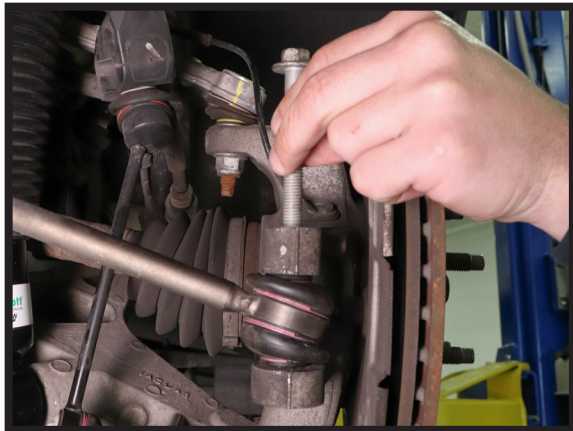

FIGURE 19

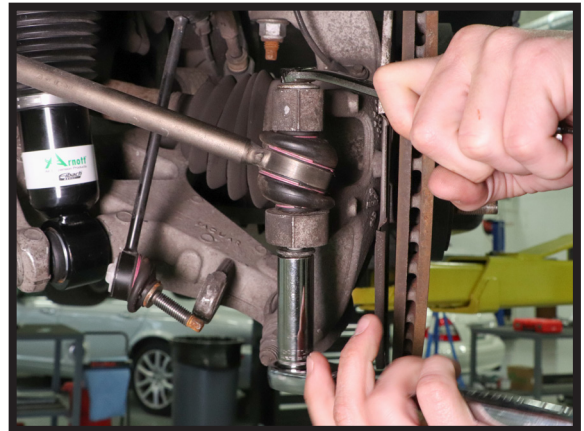

FIGURE 20

5. INSTALL SWAY BAR END LINK/NUT AND TIGHTEN TO MANUFACTURER'S SPECIFICATIONS. (FIGURES 21, 22)

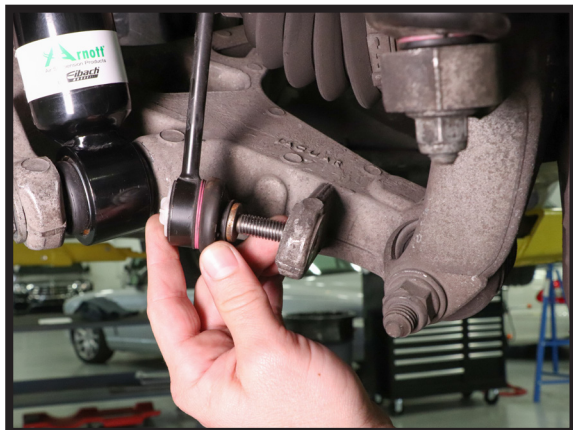

FIGURE 21



FIGURE 22



6. LOWER THE VEHICLE TO APPROPRIATE HEIGHT AND REINSTALL THE FOUR (4) TOP MOUNT NUTS. TIGHTEN TO MANUFACTURER'S SPECIFICATIONS. (FIGURE 23)



FIGURE 23

7. INSTALL THE AIR FITTING PROVIDED IN THE KIT TO EXISTING AIR HOSE USING THE FIGURE BELOW AS AN EXAMPLE. (FIGURE 24)

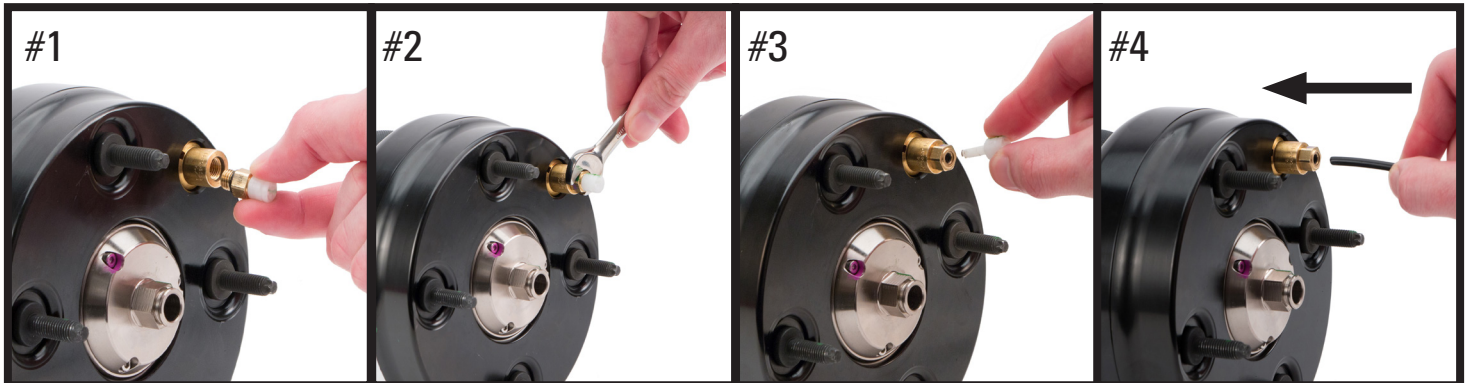

#1  
THREAD THE INCLUDED AIR LINE FITTING INTO THE VALVE

#2  
TIGHTEN FITTING TO APPROX. 2NM (18 IN-LBS/1.5 FT-LBS)

#3  
REMOVE AND DISPOSE OF THE SHIPPING PIN

#4  
INSERT AIR LINE INTO THE AIR LINE FITTING UNTIL IT STOPS

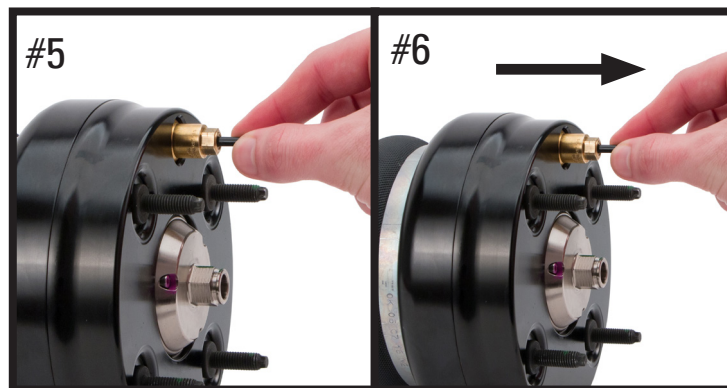

#5  
AIR LINE INSERTED

#6  
GENTLY PULL ON AIR LINE TO CONFIRM IT IS FULLY SECURED BY THE AIR LINE FITTING

FIGURE 24

8. RECONNECT THE STRUTS ELECTRICAL CONNECTION. (FIGURE 25)



FIGURE 25

9. REINSTALL ALL APPLICABLE TRUNK LINING AND SPARE TIRE COVER.
10. REINSTALL APPLICABLE REAR WHEEL.
11. LOWER THE VEHICLE.
12. INSTALLATION COMPLETE.